

SERVICE INSTRUCTIONS

SECTION

665009

SECTION 665

4-WAY HYDRAULIC VALVE

DATE

DATE 1-26-77

DESCRIPTION

TYPE 1/4" Directional Control Valve
 PRESSURE RANGE 0 to 5,000 P.S.I.
 FLOW RATE 12 Gallons/minute
 TEMPERATURE (FLUID) 160°F (maximum)

HOW SHIPPED

This unit is shipped complete in one carton.

INSTALLATION

Refer to Figure

1. Remove valve from carton.
2. Check contents of package to assure all items are included in package.
3. Place valve (number 1) on it's side.
4. Remove plate (number 2) from bottom of valve by removing four retainers.
5. Unscrew four (4) screw (number 4) from valve (number 1).
6. Pull plate (number 5) from valve cover. The plate is attached to a chain that is connected to valve (number 1) casting.
7. Remove plastic plugs (number 3) from valve (number 1).
8. Place five "O" Rings (number 6) into counter-bored holes on bottom of valve (number 1).
9. Place valve (number 1) into mounting position on subplate (number 8) and insert 1/4" bolts (number 7) into valve (number 1).
10. Replace plate (number 5) to valve (number 1).
11. Replace screws (number 4) valve is now ready for operation.

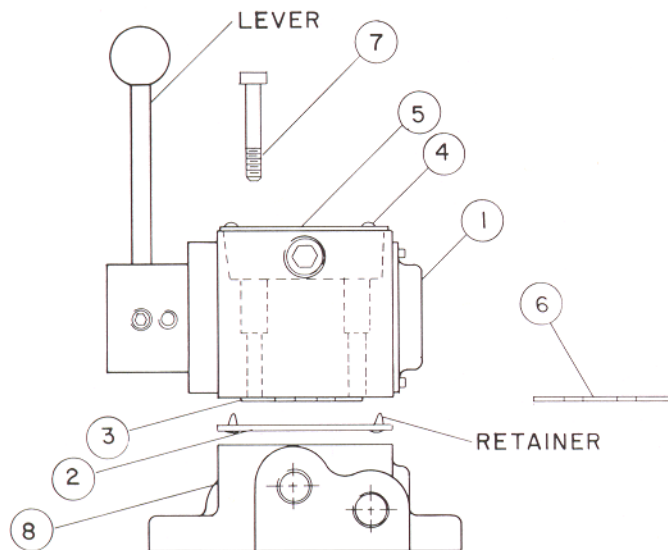

1. Valve
2. Lower Plate
3. Plastic Plug (5)
4. Screw (4)
5. Top Plate
6. "O" Ring (5)
7. Screw (4)
8. Base

THE ARO CORPORATION
BRYAN, OHIO, U. S. A.